



MFC

Microwave Filter Company, Inc.

Creating Filters and Components to 50 Ghz for Over 50 Years!

Designed for transmit applications, this filter provides deep rejection of the receive band with minimal effect on transmissions.

Specifications:

Passband:	27.5 - 31 GHz
Insertion Loss:	0.10 dB Typ
VSWR:	1.17:1 Max
Group Delay Variation:	0.1 nS Max
Reject Band:	18.2 - 22 GHz
Rejection:	100 dB Min
Flanges:	See Chart
Dimensions:	2.46" x 0.75" x 0.75" (62 mm x 19 mm x 19 mm)
Finish:	Gloss White Polyurethane

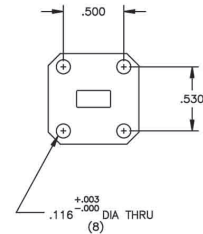
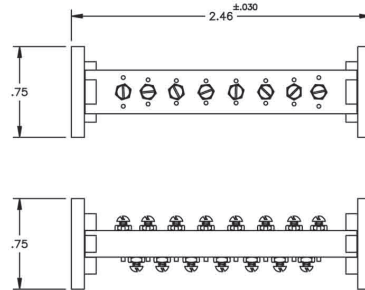

• For **WR34** Cover Flange Configuration - See model **18380**

Flange Configurations

Model #	Input	Output
18485	WR28 Cover	WR28 Cover
18485-1	WR28 Grooved	WR28 Grooved
18485-2	WR28 Cover	WR28 Grooved
18485-3	WR28 Grooved	WR28 Cover

K-Band Receive Reject Filter

Model 18485

All MFC Products Designed and Manufactured in the USA



E-Mail: Sales@iktechcorp.com