



# MFC

**Microwave Filter Company, Inc.**

**Creating Filters and Components to 50 Ghz for Over 50 Years!**

**K-Band Receive Reject Filter**  
Model 19588 Series

Designed for transmit applications, these compact filters provide good rejection of the receive band with minimal effect on the transmit band.

**Specifications:**

Passband:	27.5 - 31 GHz
Passband Loss:	0.10 dB Typ
Passband VSWR:	1.22:1 Max
Rejection:	40 dB Min from 18.2 – 22 GHz
Flanges:	See Chart (below)
Operating Temp. Range:	-30°C to +40°C
Dimensions:	1.00" x 0.75" x 0.75" (25.4 mm x 19 mm x 19 mm)
Finish:	Gloss White Polyurethane

**Flange Configurations**

Model #	Input	Output
19588	WR28 Flat Cover	WR28 Flat Cover
19588-G/F	WR28 Grooved Cover	WR28 Flat Cover
19588-F/G	WR28 Flat Cover	WR28 Grooved Cover
19588-G/G	WR28 Grooved Cover	WR28 Grooved Cover

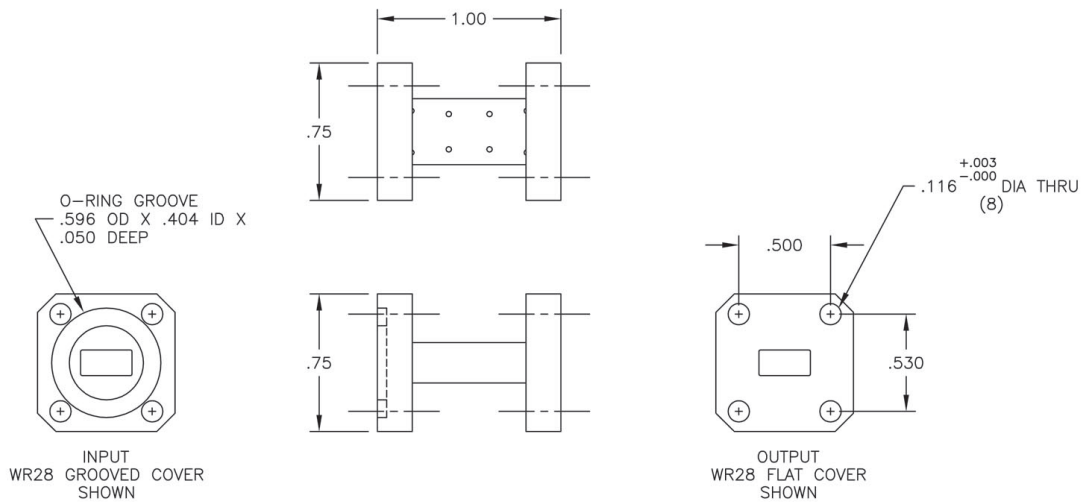

**All MFC Products Designed and Manufactured in the USA**



**E-Mail: [Sales@iktechcorp.com](mailto:Sales@iktechcorp.com)**