

S Band Mobile Satellite TV Antenna

1. Drawing:

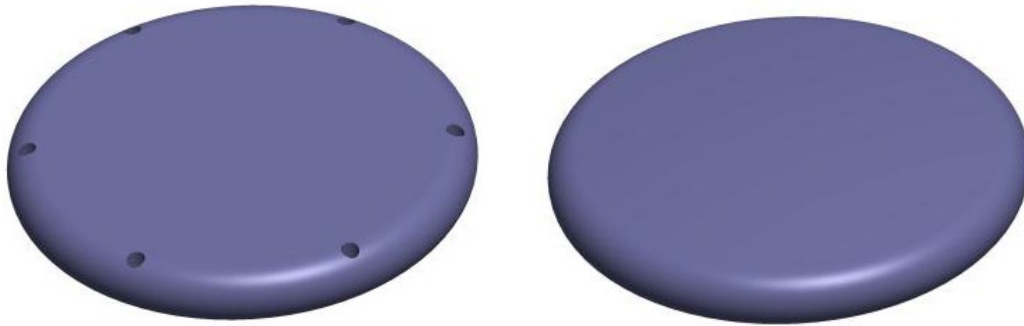

2. Radiation Pattern:

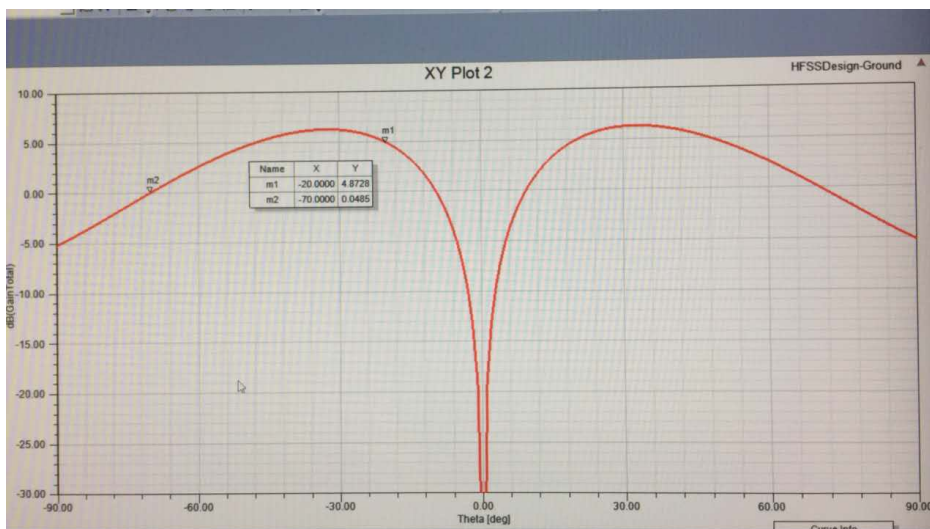
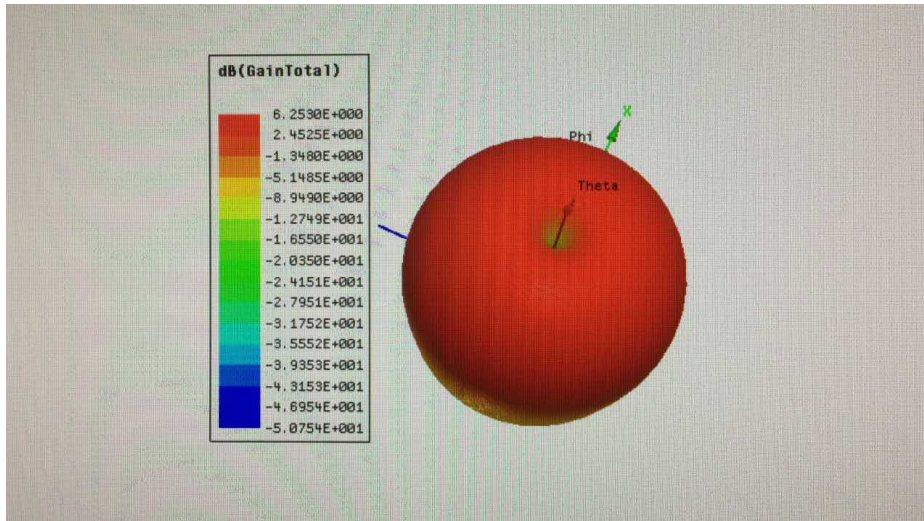

China Starwin Science&Technology Co., Ltd.

Tel: +8629-88664381, E-mail: sales@starwincom.com, <http://www.starwincom.com>

Copyright©2019 Starwin

3.Main Specification:

*Operation Frequency: 2600~2655MHz

*Polarization: RHCP&LHCP Switchable by a button

*G/T: >-19dB/K @ elevation 20°;
>-17dB/K @ elevation 30°;
>-14dB/K @ elevation 60°;
>-15dB/K @ elevation 70°;

*Cross Polarization: >15dB @ elevation 20°;
>20dB @ elevation 40°;
>15dB @ elevation 70°;

(Try to reach cross polarization specification's request, final products subject to the actual production)

*Noise Figure: <0.8dB

*Active Gain: a)19dB;
b) 27dB;
c) >30dB;

*LO Phase Noise: -50dBc@1KHz;
-75dBc@10KHz;
-95dBc@100KHz;

*Output P1dB: >0dBm

*Size: 5.91" × 0.79"/15cm × 2cm (Diameter×Height)

*DC Voltage: 12V

4.Configuration:

* Flat panel antenna with filter

* Outer cover

* LNB